



# BX1689

## 2010-13 Chevy Equinox 2010-13 GMC Terrain SLT Installation Instructions

Serial Number

**Please read BOTH these Installation Instructions and the General Towing Instructions before attempting to install or operate this equipment.**

- Blue Ox® towing products and accessories are intended to be installed by Blue Ox® Dealers who are familiar with our products and have the equipment and knowledge to do “fit work.” When necessary, Blue Ox® Dealers can be found at [www.blueox.com](http://www.blueox.com) or by contacting our Customer Care Department at (402) 385-3051.
- Many Blue Ox® Baseplates are designed to use existing holes and hardware to mount the baseplate to the towed vehicle. Even though bolts are there, do not assume they are adequate for baseplate mounting. Always use hardware supplied in the hardware kit or existing hardware specified in the Baseplate Towing Installation Instructions.

Attachment Tab Height: 15-1/2”  
Attachment Tab Width: 24”

<b>Bolt Torque Specifications</b>		
Torque in Foot-Pounds for Metric Bolts		
Bolt Size	Grade 8.8	Grade 10.9
6MM	6	8
8MM	16	22
10MM	31	40
12MM	54	70
14MM	89	117

**Confirm the towability and pre-towing procedures for your vehicle with the owner’s manual or contact the vehicle’s manufacturer for specific towing procedures.**

<b>Bolt Torque Specifications</b>		
Torque in Foot-Pounds for Inch Bolts		
Bolt Size	Grade 5	Grade 8
1/4”	10	14
5/16”	19	29
3/8”	33	47
7/16”	54	78
1/2”	78	119
5/8”	154	230

**Do not use the towed vehicle for storing luggage, equipment, etc. This may cause you to exceed the towing capacity of the tow bar, baseplate, and its accessories.**



**If the front of your vehicle looks different than these models, call us at (402) 385-3051.**

**BX1689**  
**2010-13 Chevy Equinox**  
**2010-13 GMC Terrain SLT**  
**Installation Instructions**

**Parts List**

Ref. No.	Qty.	Part #	Description
1	1	61-6693	WLDM'T, BP, BX1689
2	6	61-5208	WLD, NUT PLT, 1/4 X 1 X 1, 3/8" WITH 14" WIRE
3	6	201-0444	3/8-16 X 2 HEX BOLT GRADE 5, ZP.
4	2	201-0440	3/8-16 X 1 1/2 HEX BOLT, GRADE 5, ZP
5	8	203-0010	3/8 LOCK WASHER, ZP
6	2	202-0090	3/8-16 HEX NYL. INS. LOCK NUT, ZP
7	2	201-0553	1/4-20 X 1/2 HX.WSHD.TYPE F TCS, ZP
8	2	201-0192	10-32 X 1/2 SLOT, RD. HD. SCREW
9	2	203-0054	#10 LOCK WASHER
10	2	202-0047	#10-32 HEX NUT
11	2	101-5822	ADAPTER, 4 WAY CONNECTOR
12	2	102-7056	BREAKAWAY / COOLANT BRACKET
13	6	201-0050	1/4-20 X 3/4 HEX BOLT GRADE 5, ZP
14	4	202-0069	1/4-20 HEX FLANGE WHIZ LOCK NUT, ZP
15	2	62-3469	ATT TAB ASSY, REM, SF/LB, 1 HOLE
16	1	102-7134	BREAKAWAY BRACKET
17	2	202-0102	1/4-20 HEX NYL NUT, ZP
	2	226-0046	BASEPLATE SAFETY CABLE, 36" CL III (Not Shown)
	2	229-0359	QUICKLINK, 3/8, ZP (Not Shown)
	2	290-0437	RECEIVER, CAP PLUG (BLK) (Not Shown)

**Tools Required**

- 7MM Socket
- 10MM Socket
- 7/16" Socket/Wrench
- 9/16" Socket/Wrench
- 5/8" Wrench
- 3/8" Nut Drivers
- T20 Torx
- Large Vise Grip
- Reciprocating Saw
- Drill
- 13/32" Drill Bit
- Flat Screwdriver
- Utility Knife
- Tape Measure
- 1" Hold Saw
- Loctite® RED

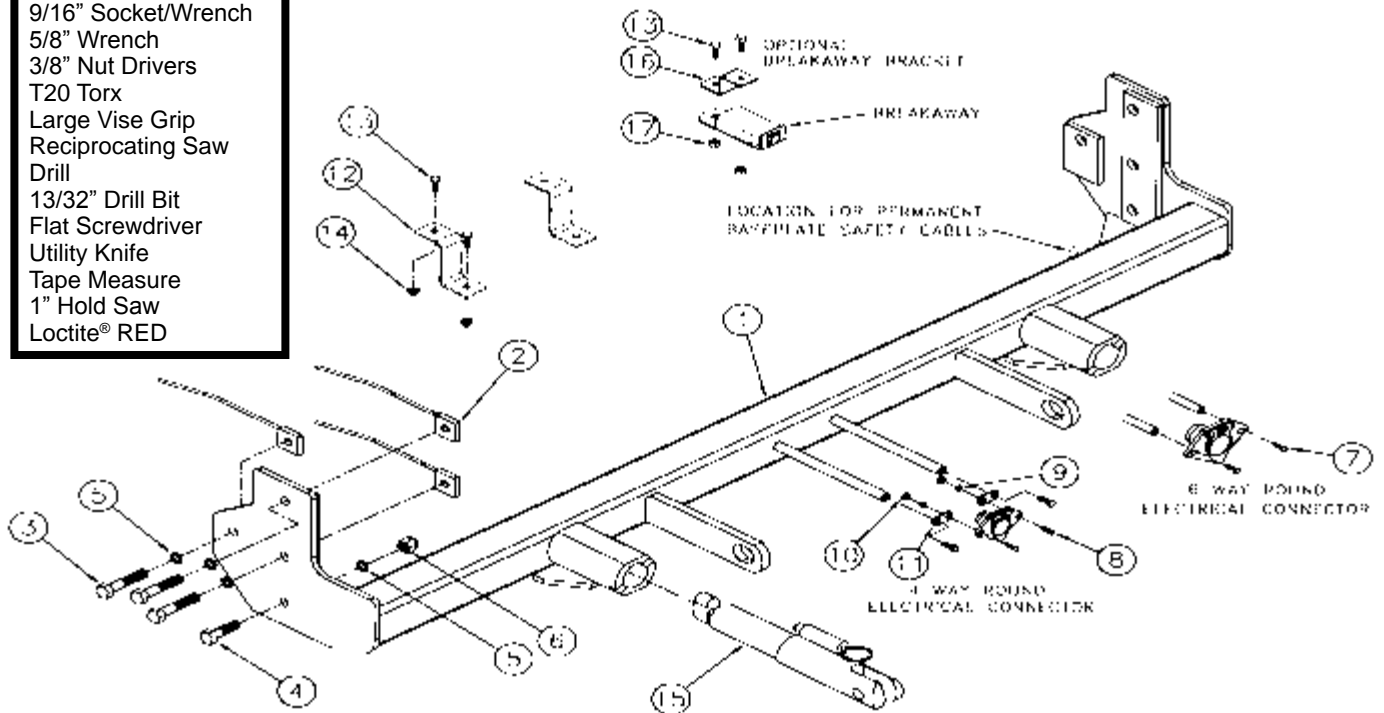

**Important:**

Use only genuine factory replacement parts on your baseplate. Do NOT substitute homemade or non-typical parts. If a bolt is lost or in need of replacement, for your safety and the preservation of your baseplate, be sure to use a replacement bolt of the same grade (In most cases it will be Grade 5, please reference the parts list above). Replacement parts may be ordered through your nearest Blue Ox® Dealer or Distributor. Failing to follow and/or altering these installation instructions in either installation or required equipment will void the manufacturer's warranty.

BX1689  
2010-13 Chevy Equinox  
2010-13 GMC Terrain SLT  
Installation Instructions

**Vehicle Weight:** Due to the design of the removable tabs, the RangeFinderII tow bar can not be used. Adapters, except the BX8833 and BX88151, can not be used with this baseplate.

**Installation Notes:** The fascia, air baffle, bolts and push pins are removed and reinstalled during installation of the baseplate. Drilling is required. Trimming is required.

The dimensional variations between otherwise identical vehicles can be considerable. While the baseplate was designed for easy installation, it may be necessary to tailor the baseplate slightly to compensate for auto manufacturer's tolerances. These minor adjustments may include filing a hole slightly, bending electrical rods or bending end plates.

The BX8869 Bulb & Socket Wiring Kit is recommended for this vehicle.



1. Using a T20 Torx, remove two screws across the front. Two on each side of the middle. Set the screws aside to be reinstalled later.

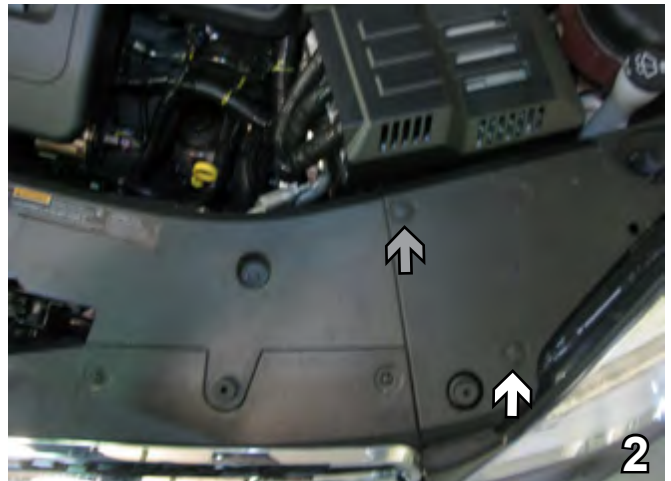

2. Remove the push pins from the flat plastic piece on top (white arrow).  
**Equinox:** Also remove the push pin indicated by the gray arrow. Do this to both sides of the vehicle, two on each side. Set push pins aside to be reinstalled later.

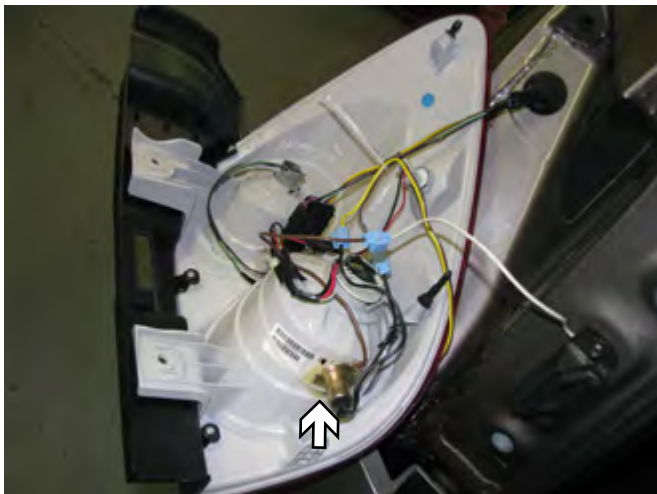

**Possible location for the Bulb and Socket Wiring Kit (BX8869)**

**Handling of some cosmetic parts when installing this product may require the use of protective covers, rags, specialty tools, etc. to prevent damage.**

BX1689  
2010-13 Chevy Equinox  
2010-13 GMC Terrain SLT  
Installation Instructions



3. Using a T20 Torx, remove screw above the push pins just forward of the front tire on the wheel well (white arrow).

**Equinox:** Using a 7MM socket, remove the bolt above the screw (gray arrow). Do this to both sides of the vehicle. Set screws and bolts aside to be reinstalled later.



4. Using a flat screw driver, remove three push pins just forward of the front tire on the wheel well. Do this to both sides of the vehicle. Set push pins aside to be reinstalled later.



5. Using a 7MM socket, remove two bolts from the lower edge of the fascia. Do this to both sides of the vehicle. Set bolts aside to be reinstalled later.

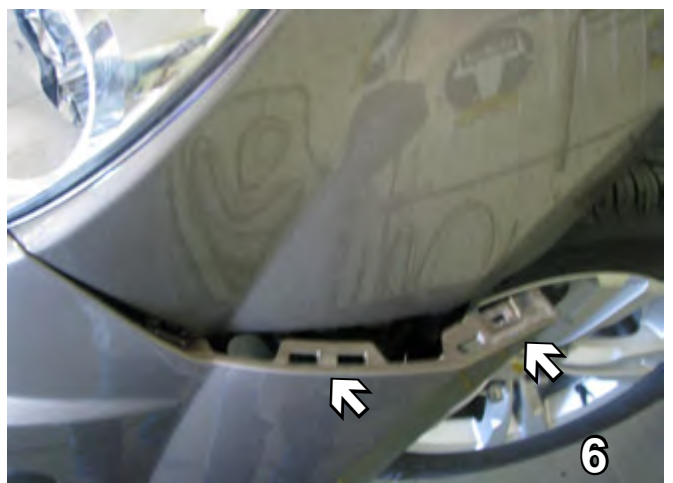

6. The fascia is then ready to be removed from the vehicle. Pull fascia corners to the side of vehicle to release, then pull fascia forward. Do this on both sides. Then set fascia aside carefully to be reinstalled later.

BX1689  
2010-13 Chevy Equinox  
2010-13 GMC Terrain SLT  
Installation Instructions

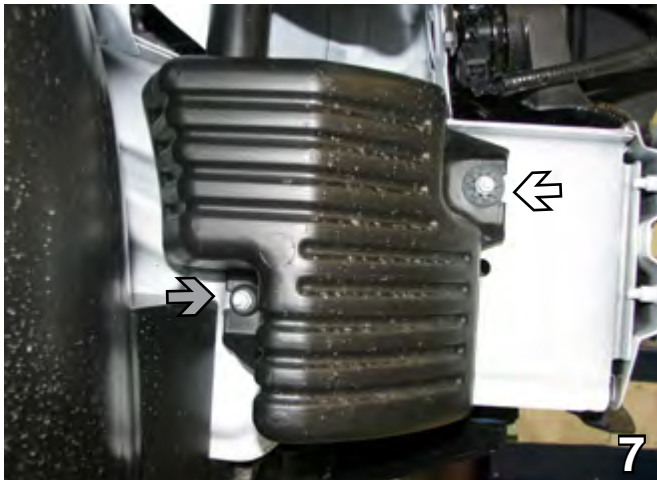

7. On the passenger side, using a 10MM socket, remove the bolt from the front of the air baffle. **Terrain:** Remove the additional bolt indicated by the gray arrow. Pull the air baffle away from the frame. Set the bolt aside to be reinstalled later.

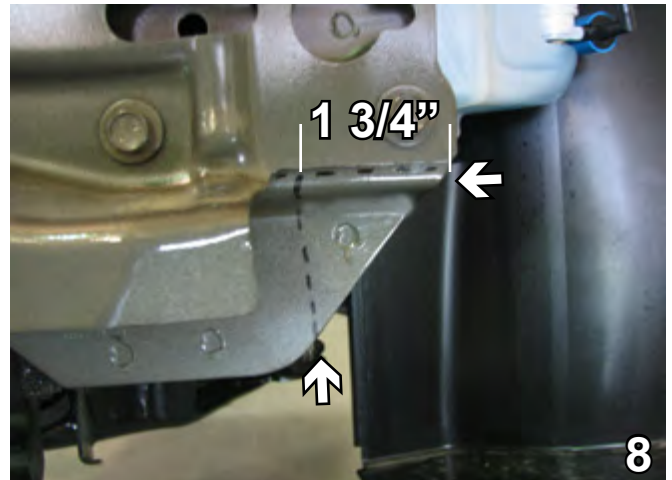

8. **Equinox:** Using a reciprocating saw, trim the frame 1 3/4" over across the edge and straight down. Do this on both sides.

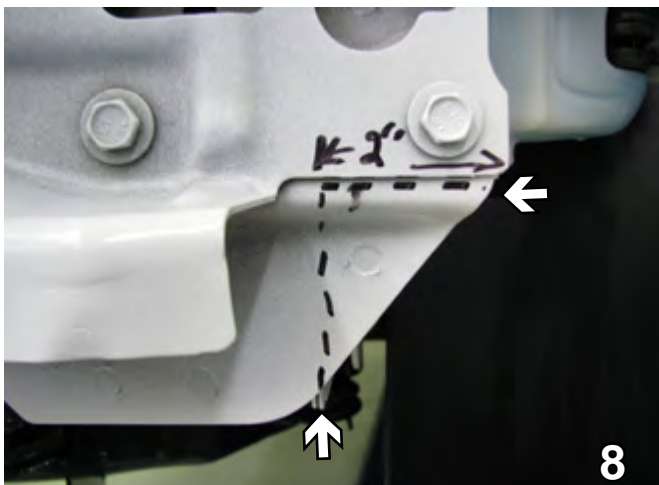

8. **Terrain:** Using a reciprocating saw, trim the frame 2" over across the edge and straight down, flush with the back of the frame. Do this on both sides.



9. Using the large vise grip, straighten out the end to a 90° angle. Do this on both sides.

BX1689  
2010-13 Chevy Equinox  
2010-13 GMC Terrain SLT  
Installation Instructions

**Steps 11-13 are only for models with a transmission condenser**



10. On the passenger side behind the bumper, move the temperature sensor and zip tie it.



11. Unbolt the coolant line and set it down, out of the way.

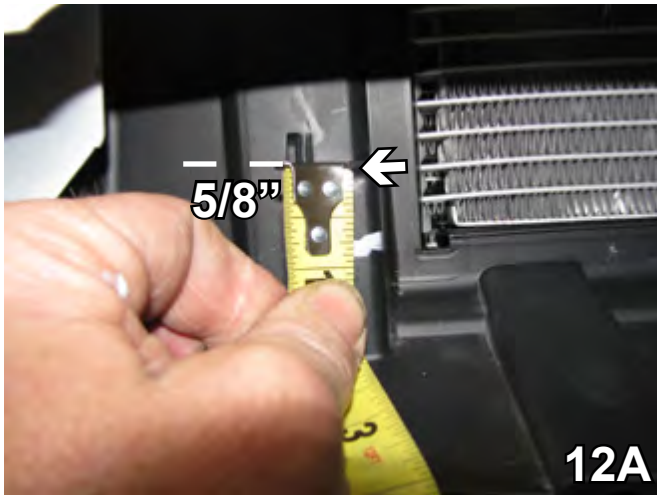

12. Cut down 5/8" (11A) and 1/2" (11B) back, notch out the area so that the baseplate will not hit.

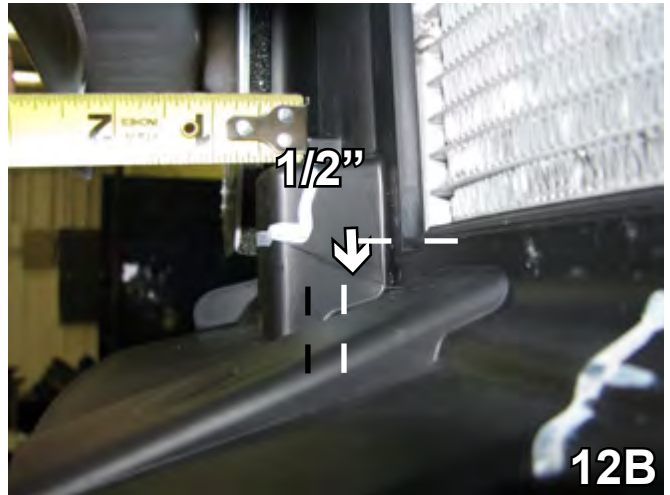

BX1689  
2010-13 Chevy Equinox  
2010-13 GMC Terrain SLT  
Installation Instructions



13. Notch back the center area until the plastic goes vertical.

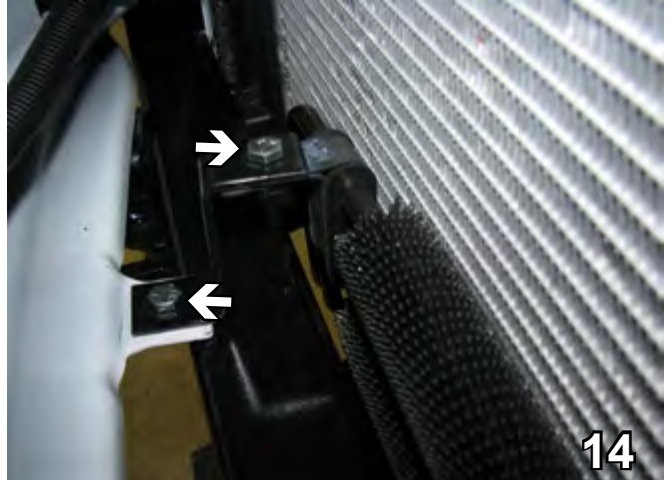

14. If equipped with coolant reservoir, attach coolant brackets to the baseplate and remount the coolant line to the brackets. Use 1/4-20 x 3/4" hex bolts and 1/4-20 whiz nuts.

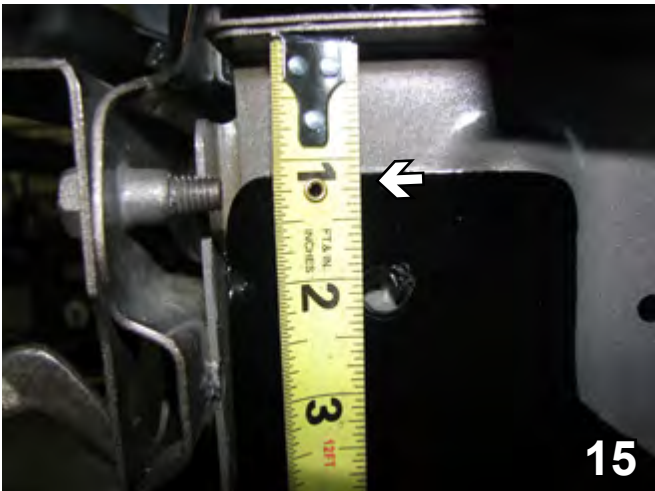

15. Slide the baseplate straight up, from the top of the frame down to the baseplate should be 1 1/8". Do this on both sides.

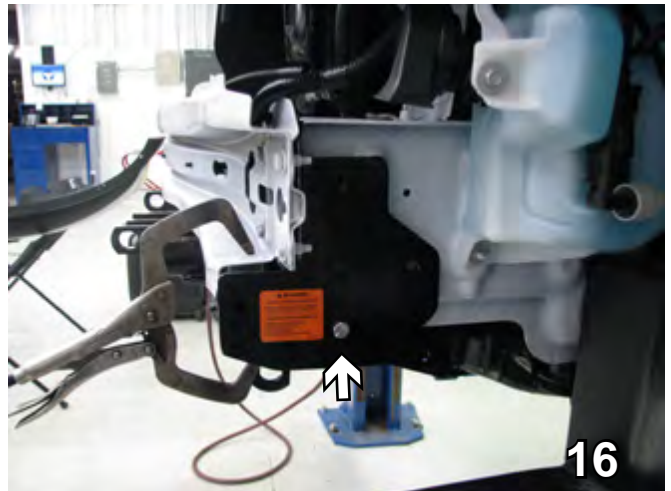

16. Using the large vise grip, clamp the baseplate to the frame. Using the baseplate as a template, drill the bottom hole on each side with a 13/32" drill bit. Insert 3/8-16 x 1 1/2" hex bolt with 3/8" lock washer and 3/8-16 nut. Use Loctite Red on all bolts. Do this to both sides. Be sure the baseplate is level. Drill the remaining three holes.

When using power drills be aware of the dangers of torque and drill bit length.

BE SURE TO USE LOCTITE® RED ON ALL BOLTS BEFORE TIGHTENING. TIGHTEN ALL BOLTS ACCORDING TO THE TORQUE CHART ON THE FRONT PAGE OF THESE INSTRUCTIONS OR ON PAGE 3 OF THE BASEPLATE TOWING GENERAL INSTRUCTIONS.

BX1689  
2010-13 Chevy Equinox  
2010-13 GMC Terrain SLT  
Installation Instructions

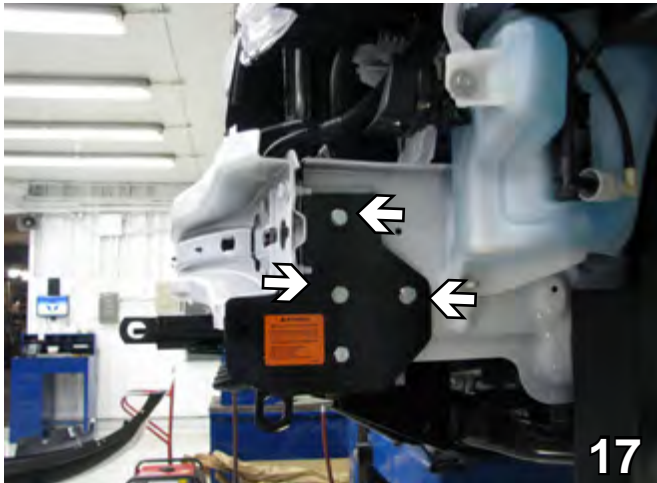

17. Insert 3/8-16 x 2" hex bolts, 3/8" lock washers with Loctite Red. Attach to 3/8" nut plates inserted into the frame and tighten. Do this to both sides of the vehicle.

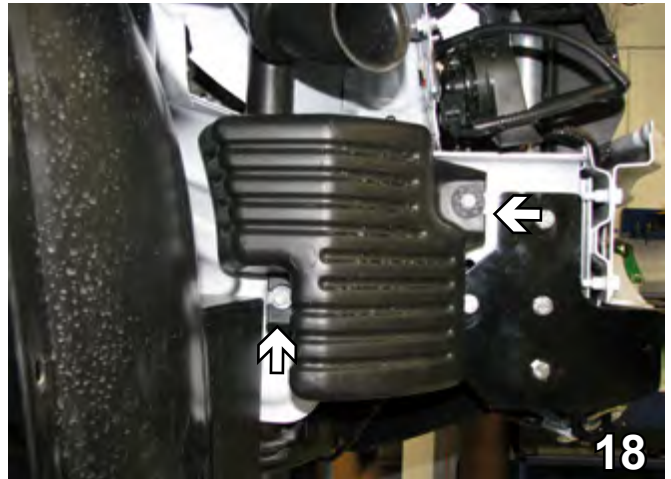

18. Reinstall the air baffle. Put three washers behind the air baffle on each bolt to move the air baffle out from the frame.



19. Attach the permanent baseplate safety cables to the provided convenience link on the baseplate (see white arrow). The photo above shows the recommended installation of the cables to frame of vehicle. Additional options may interfere with suggested mounting; in this case secure the cables to a solid piece of the frame as described in the instructions included with the permanent baseplate safety cables. Be sure the safety cables do not rub against any hoses or moving parts. Do this to both sides of the vehicle.



20. **Optional:** Using a 9/32" drill bit, drill a hole into the bottom side of the bumper centered between the electrical rod and the convenience link. Attach the bracket with 1/4-20 x 3/4" hex bolt and 1/4-20 hex nut (white arrow). Fasten the breakaway to the bracket with a 1/4-20 x 3/4" hex bolt and 1/4-20 hex nut (gray arrow).



BX1689  
 2010-13 Chevy Equinox  
 2010-13 GMC Terrain SLT  
 Installation Instructions

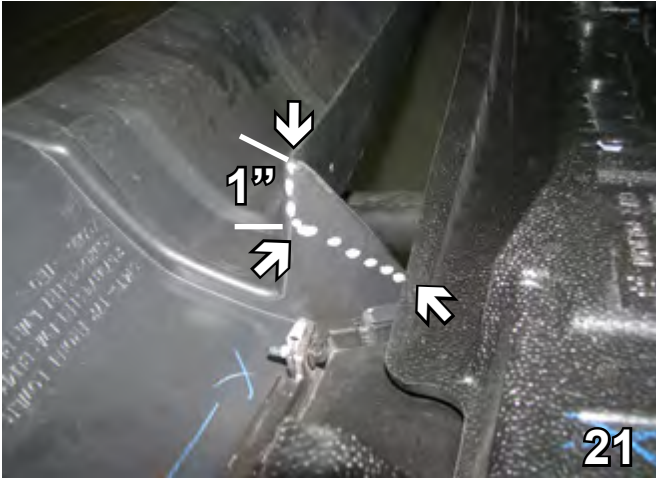

21. **Equinox:** On the back side of the fascia, trim out the opening, go down 1" and veer off to the edge. Do this to both sides.

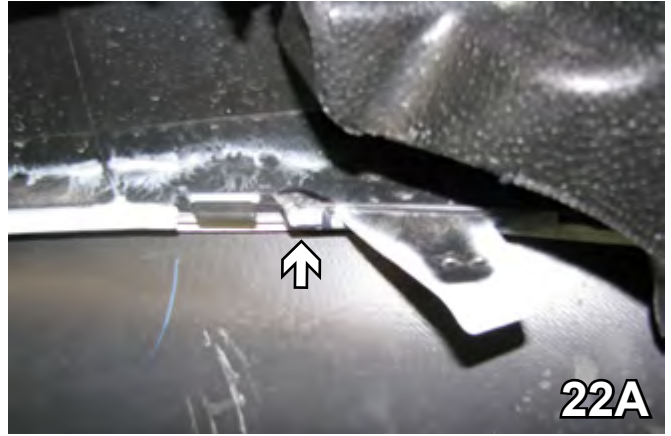

23. Reinstall the fascia. Attach the electrical bracket to the center of the fascia.

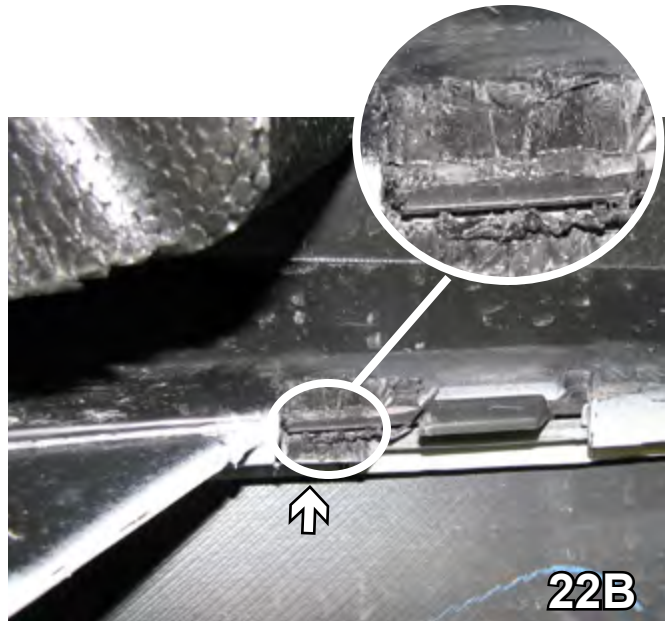

22. As you put the fascia back on it will hit the baseplate, as shown, mark and notch out a little of the corner. Do this on both sides.

Install the tow bar and safety cables according to the instructions provided in their packages. When demonstrating this to the customer, be sure to include all the contents and packages.

Do **NOT** substitute other devices if the tow bar pins and clips are misplaced.

Be sure that **ALL** electrical connections are plugged in properly and functioning **BEFORE** installing the fascia.

**DEALER or INSTALLER:**  
 Be certain the user receives the instruction sheets for their products.

If the baseplate is in an accident, it must be replaced. **DO NOT** use it again! An accident can cause unseen damage and using it again could result in more damage or serious injury. **DO NOT** use the baseplate if it is damaged or missing parts.

BX1689  
2010-13 Chevy Equinox  
2010-13 GMC Terrain SLT  
Installation Instructions



**Shown without removable tabs installed**



**Shown with removable tabs installed**



**Shown with removable tabs installed**

## CUSTOMER SERVICE COMMITMENT

Blue Ox is committed to providing you with exceptional customer care throughout your lifetime with our products. Our team is here to assist you with any questions you may have regarding the performance of your product. Simply call (402) 385-3051 and you can speak with our customer care team.

Additionally, please visit our website to see which rallies our Destination America team will be attending. For a nominal fee, our service technician will service your towing system to ensure it's in proper working condition. Also, as a commitment to our customers, should you visit our factory, you can stay at our full service Blue Ox campground at no charge along with enjoying a factory tour.

Again, thank you for being our customer and for the confidence you have shown in the performance of our products. It is because of customers like you we enjoy the success we have today.



© 2011 Blue Ox  
One Mill Road, Industrial Park  
Pender, Nebraska 68047  
Phone: (402) 385-3051 • Fax: (402) 385-3360  
[www.blueox.com](http://www.blueox.com)